

GENERAL TOLERANCES UNLESS SPECIFIED				
X +/-0.50	X.X +/-0.25	X.XX +/-0.1	X +/-1°	X.X +/-0.5°
FLATNESS & SQUARE TOLERANCES:		M/C +/-0.2	FABRICATION: +/-1	

UNLESS SPECIFIED IN CONTRACT ALL WELDS MUST BE PRODUCED BY QUALIFIED WELDERS TO BS EN287-1: 2004 - WELDING SYMBOLS TO BS499-2: 1980

REV.	DATE	DESCRIPTION	ISSUED SIG
A	22/01/2010	FIRST ISSUE	NJ

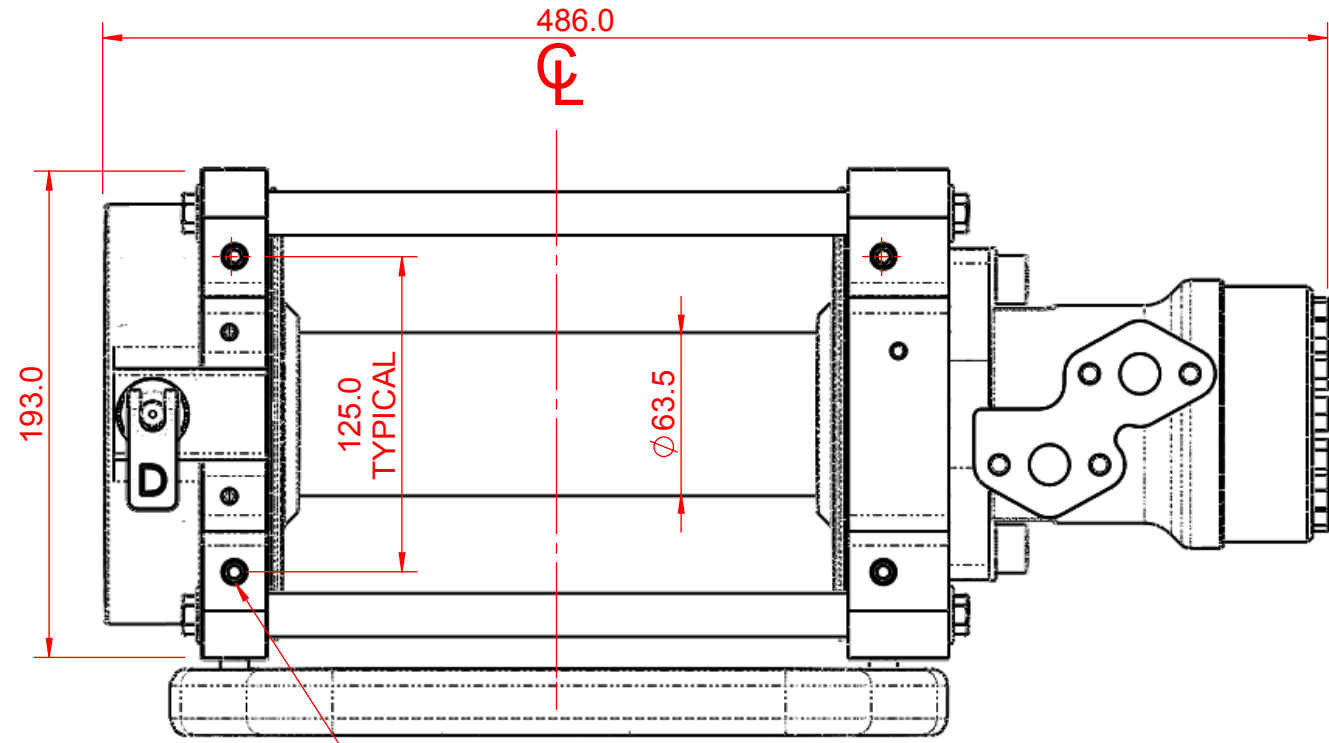

M10 TYP ON ALL 4 FACES

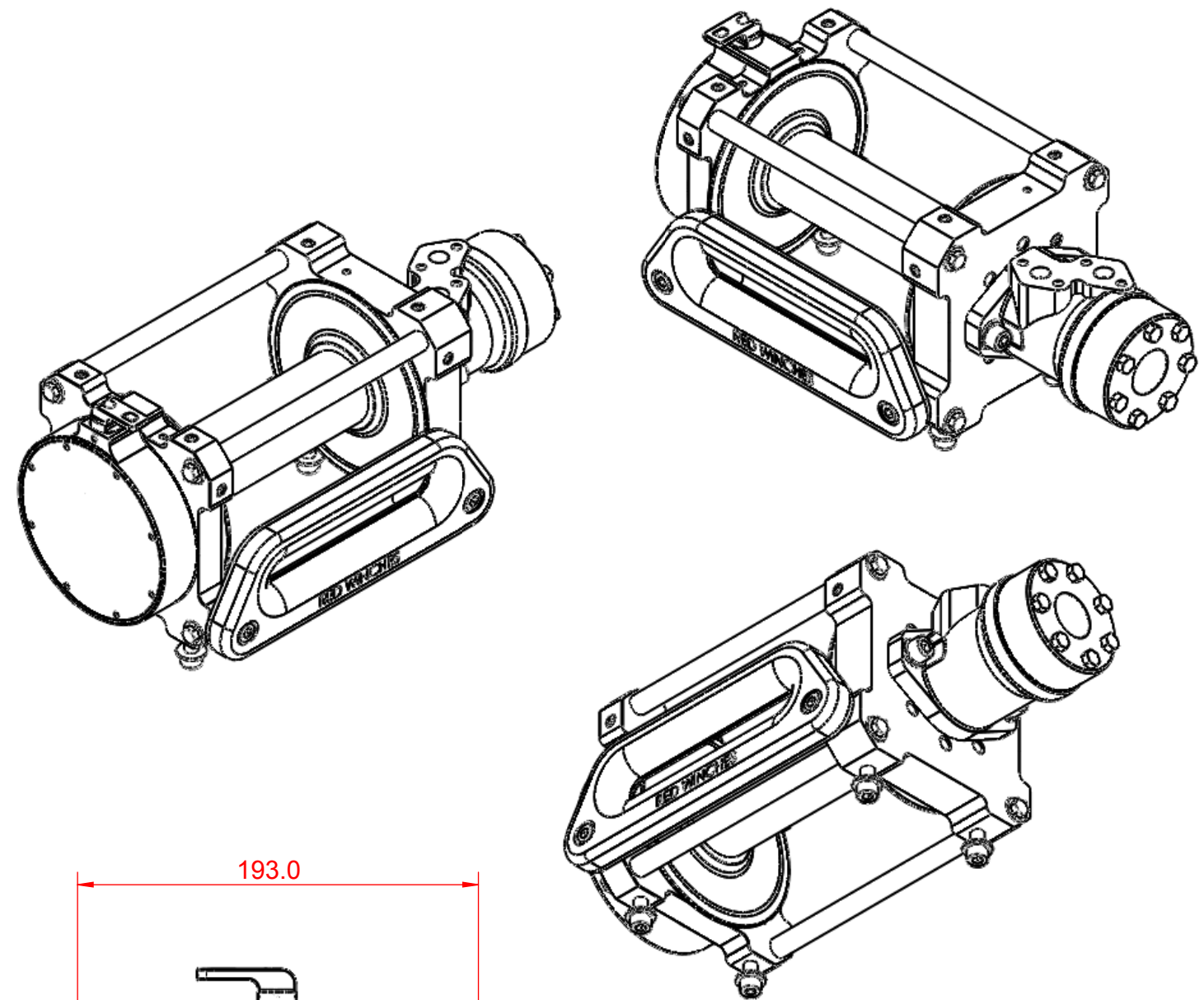
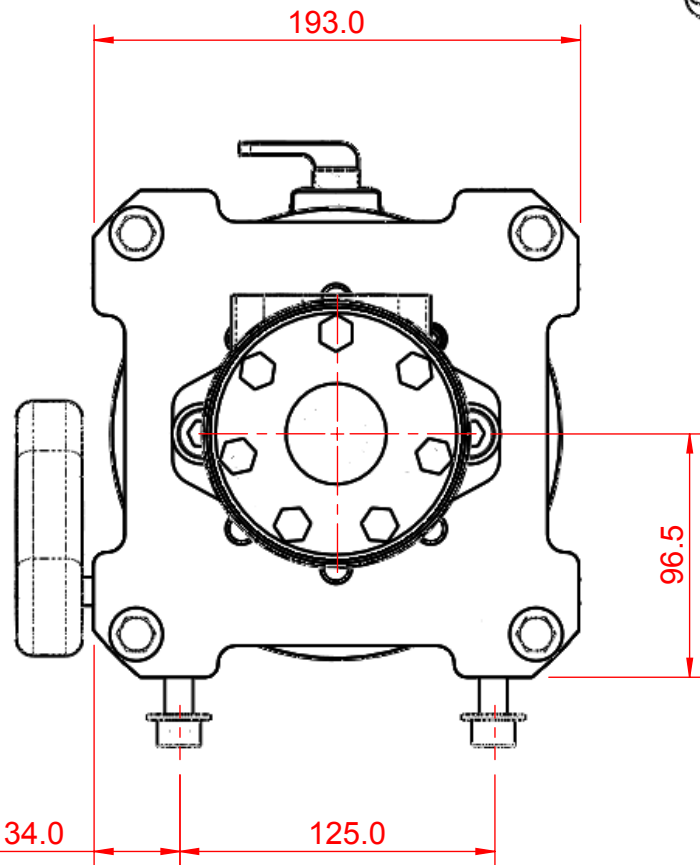
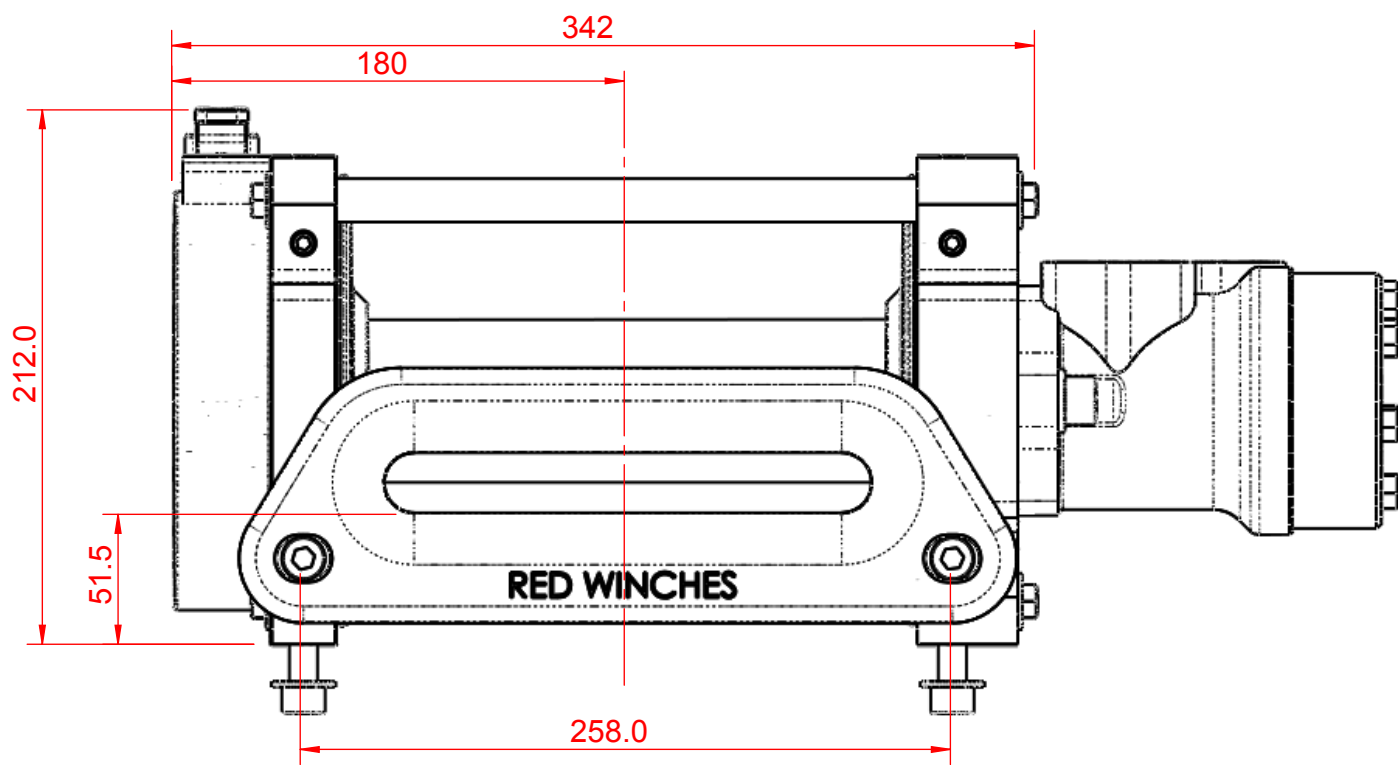

UNLESS SPECIFIED	
FASTENER	TORQUE
M6	10 Nm
M8	24 Nm
M10	45 Nm
M12	80 Nm
M16	160 Nm
M20	200 Nm

APPROX MASS: 27Kg

<b>Redstart//Design Ltd</b> Professional Engineering Resource Tel: +44 (0)1460 67744 Fax: +44 (0)1823 261070 www.redstart-design.com		FORMAT <b>A3</b>	DRAWN N.Jones	DATE 19/01/2010
		QTY REQ 1	CHECKED K. Hammon	DATE 19/01/2010
DRAWING DESCRIPTION: <b>TERRIER WINCH - COMMERCIAL</b>				
MATERIAL: ALUMINIUM ALLOY: ANODISED RED				
FINISH: DRUM FINISH: MATT BLACK				
DRAWING NUMBER: <b>TERRIER_C-MA-01</b>	USED IN ASSY / FAB VARIOUS	SCALE <b>1:3</b>	REVISION <b>A</b>	SHT 1 OF 2
Drawing not to be reproduced or distributed in any form without specific permission from Redstart//Design.				

PROJECT REF: \_\_\_\_\_ PROJECT DESCRIPTION: \_\_\_\_\_

GENERAL TOLERANCES UNLESS SPECIFIED

X +/-0.50	X.X +/-0.25	X.XX +/-0.1	X +/-1°	X.X +/-0.5°
-----------	-------------	-------------	---------	-------------

UNLESS SPECIFIED IN CONTRACT ALL WELDS MUST BE PRODUCED BY QUALIFIED WELDERS TO BS EN287-1: 2004 - WELDING SYMBOLS TO BS499-2: 1980

FLATNESS & SQUARE TOLERANCES:	M/C +/-0.2	FABRICATION: +/-1
-------------------------------	------------	-------------------

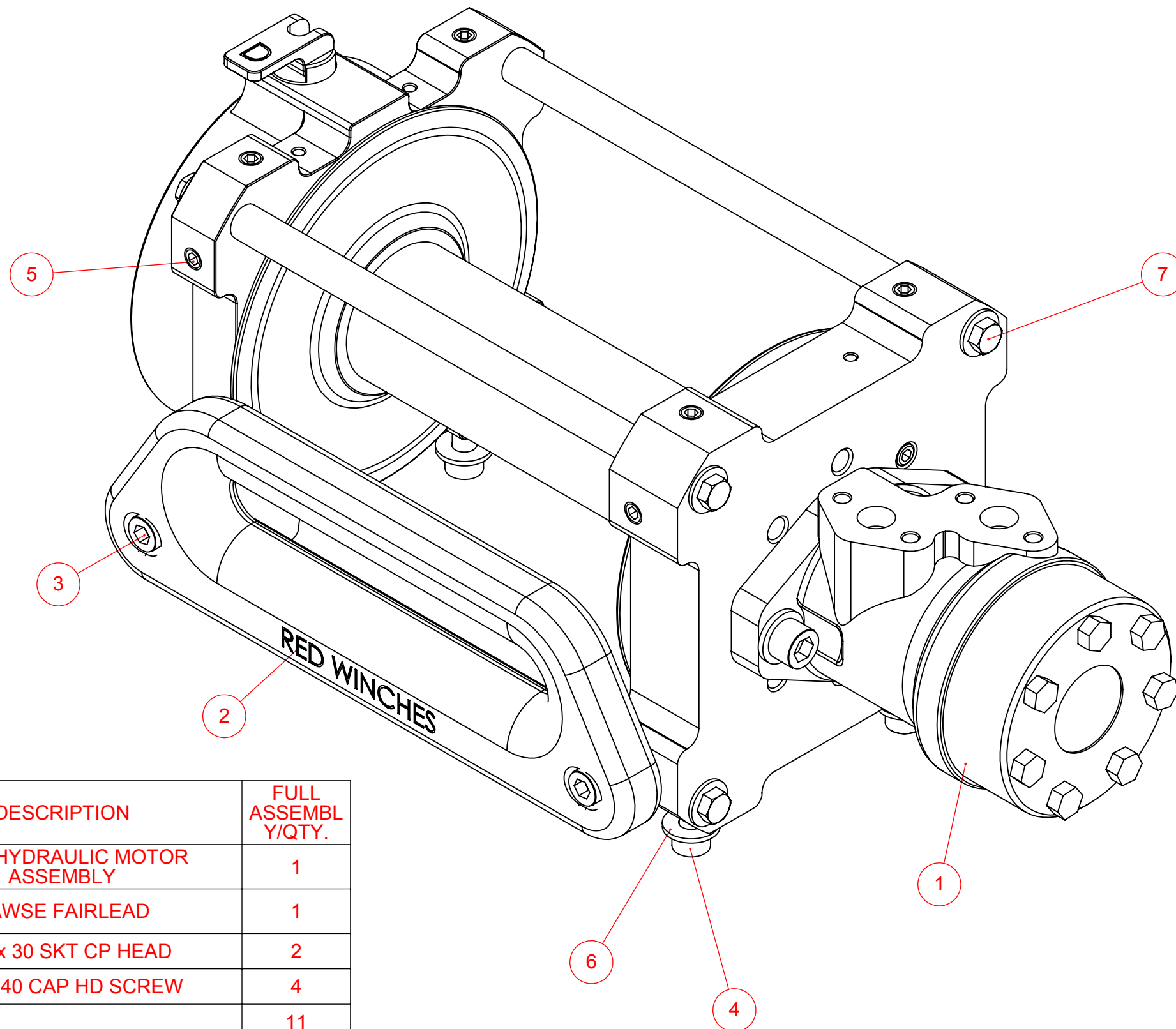

ITEM NO.	PART NUMBER	DESCRIPTION	FULL ASSEMBLY/QTY.
1	CHALLENGER-HA-02	160cc HYDRAULIC MOTOR ASSEMBLY	1
2	CHALLENGER-MD-41	HAWSE FAIRLEAD	1
3	M10 x 30	M10 x 30 SKT CP HEAD	2
4	M10 x 40	M10 x 40 CAP HD SCREW	4
5	M10 x 16		11
6	M10 FORM C	ST/STEEL WASHER M10 - FORM C	4
7	TERRIER_C-MA-02	TERRIER WINCH - COMMERCIAL	1

<b>Redstart//Design Ltd</b> Professional Engineering Resource Tel: +44 (0)1460 67744 Fax: +44 (0)1823 261070 www.redstart-design.com		FORMAT	DRAWN	DATE
		A3	N.Jones	22/10/2009
		QTY REQ	CHECKED	DATE
		1	K. Hammon	22/10/2009

DRAWING DESCRIPTION:				
TERRIER WINCH - COMMERCIAL				
MATERIAL:				
ALUMINIUM ALLOY: ANODISED RED				
FINISH:				
DRUM FINISH: MATT BLACK				
DRAWING NUMBER:	USED IN ASSY / FAB	SCALE	REVISION	SHT 2
TERRIER_C-MA-01	VARIOUS	1:2	A	OF 2
Drawing not to be reproduced or distributed in any form without specific permission from Redstart//Design.				

PROJECT REF:	PROJECT DESCRIPTION:
--------------	----------------------